

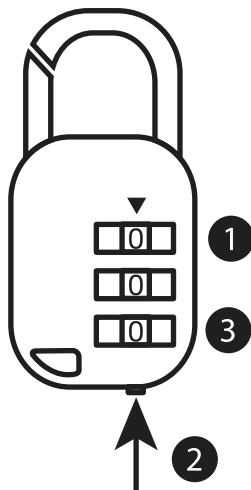

PRODUCT CARE + INSTRUCTIONS

Closing the backpack

1. Force any excess air out of the backpack.
2. Close the main zip at the top of the backpack.
3. Roll the top of the backpack down four times.
4. Connect the buckles at the top, or to the side compression straps.

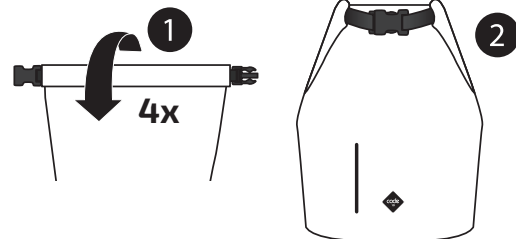

Changing the Lock Code

1. Set the code to 0-0-0
2. Push the reset button in.
3. Keeping the reset button pushed in, turn the dials to your desired number.
4. Release the reset button, test the lock.
5. Your password is ready.

Locking the backpack

1. Remove the lock from the side pocket.
2. Pull the zip closed and place the zip loop over the buckle.
3. Connect the top buckles and pull the two ends together.
4. Use the lock to secure the D-rings and Zipper puller together.

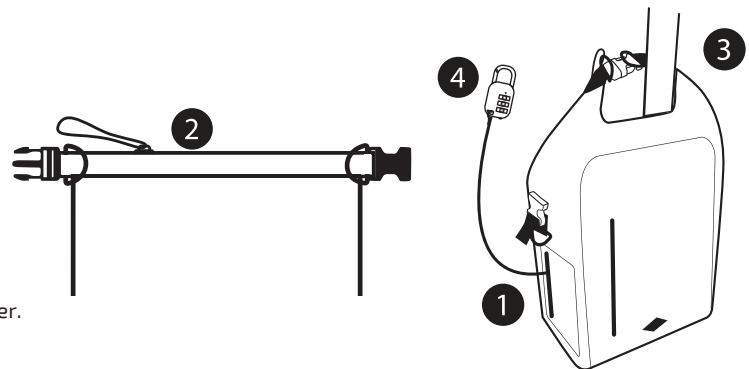

Notes:

- Carefully inspect the product before use. Look for cracks/damage to the opening, surface and seams. If any damage is apparent, do not use the product and contact us.
- Backpack is designed to be water resistant. Do not submerge the backpack in water.
- Do not use the backpack as a flotation device.
- Ensure the backpack is closed before exposing to water/moisture.
- Leave the backpack unattended at your own risk. Code 10 is not liable for any possessions lost or stolen while using the Code 10 Backpack.

Product Care:

- Do not expose to sunlight for long periods of time. Store in a cool, dry, dark place when not in use.
- Avoid using sharp objects around the bag. If bag is touched by sharp objects, or subjected to heavy shocks (drops/bumps etc) inspect carefully for damage.
- To clean the interior of the backpack, half fill with warm soapy water. Shake the backpack, pour out the water and leave to air-dry. The straps can be hand washed using soapy water and a light brush.
- DO NOT machine wash.